

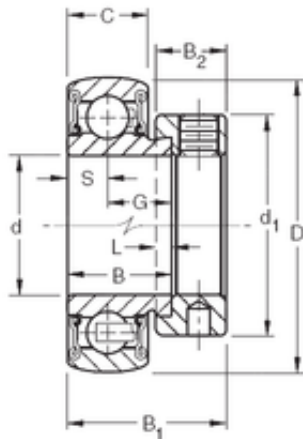

Korean motorcyclist Co., Ltd

30,1625 mm x 62 mm x 23,82 mm Timken RA103RRB Ball Insert Bearings



Bearing No. RA103RRB

Size	30.1625x62x23.82 mm
Bore Diameter	30,1625 mm
Outer Diameter	62 mm
Width	23,82 mm
d	30,1625 mm
D	62 mm
B	23,82 mm
C	18 mm
d1	44,1 mm
B1	35,7 mm
B2	15,9 mm
G	14,81 mm
L	4 mm
S	8,99 mm
Weight	0,318 Kg
Basic dynamic load rating (C)	21,8 kN

RA103RRB Bearing 2D drawings and 3D CAD models