

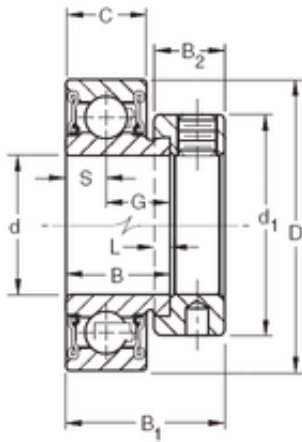

Korean motorcyclist Co., Ltd

44,45 mm x 85 mm x 30,18 mm Timken RA112RR Ball Insert Bearings



Bearing No. RA112RR

Size	44.45x85x30.18 mm
Bore Diameter	44,45 mm
Outer Diameter	85 mm
Width	30,18 mm
d	44,45 mm
D	85 mm
B	30,18 mm
C	22 mm
d1	63,5 mm
B1	43,7 mm
B2	18,3 mm
G	19,18 mm
L	4,8 mm
S	11 mm
Weight	0,68 Kg
Basic dynamic load rating (C)	36 kN

RA112RR Bearing 2D drawings and 3D CAD models