

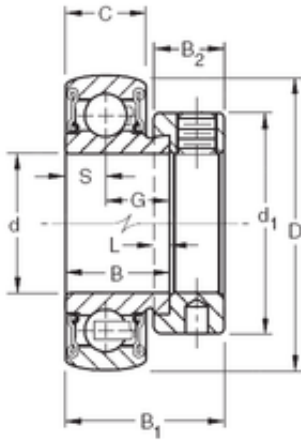

Korean motorcyclist Co., Ltd

38,1 mm x 80 mm x 30,18 mm Timken RA108RRB Ball Insert Bearings



Bearing No. RA108RRB

Size	38.1x80x30.18 mm
Bore Diameter	38,1 mm
Outer Diameter	80 mm
Width	30,18 mm
d	38,1 mm
D	80 mm
B	30,18 mm
C	22 mm
d1	60,3 mm
B1	43,7 mm
B2	18,3 mm
G	19,18 mm
L	4,8 mm
S	11 mm
Weight	0,694 Kg
Basic dynamic load rating (C)	36 kN

RA108RRB Bearing 2D drawings and 3D CAD models